

Magnets profiles CMD

Light and functional made of plasit (colour blue) 12 x magnets / length 1250 mm
All profiles are execute with a female and male adaptor to connect the profiles straight- lined.

Material : Polyurethan

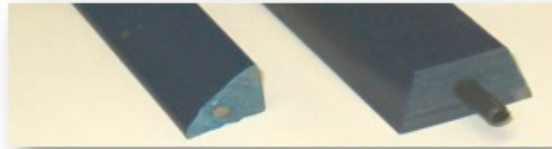
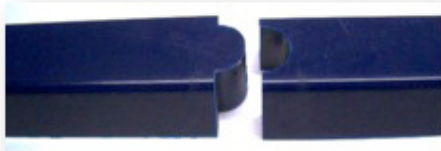

CMD-P	Sides with magnets	Dimensions (mm)	
		B	H
CMD- PD - 18 / 1	1	18,0	13,0
CMD- PD - 20 / 1	1	20,0	14,0
CMD- PD - 25 / 1	1	25,0	18,0
CMD- PD - 30 / 1	1	28,0	20,0

see table next page.

CMD-P	Sides with magnets	Dimensions (mm)	
		B	H
CMD-PS- 18 / 2	2	18,00	HYP. 25
CMD-PS- 20 / 2	2	20,00	HYP. 28
CMD-PS- 25 / 2	2	25,00	HYP. 35
CMD-PS- 18 / 1	1	18,00	HYP. 25
CMD-PS- 20 / 1	1	20,00	HYP. 28
CMD-PS- 25 / 1	1	25,00	HYP. 35
CMD-PS- 30 / 1	1	30,00	HYP. 42
CMD-PS- 40 / 1	1	40,00	HYP. 56
CMD-PS- 50 / 1	1	50,00	HYP. 70
CMD-PM- 5030	1	B 50 x b 30	50,0
CMD-PM- 5040	1	B 60 x b 40	70,0
CMD-PM- 6040 / 1 side	1	B 50 x b 40	70,0
CMD-PR- 322	1	B 30 x b 20	20,0
CMD-PR- 432	1	B 40 x b 30	20,0
CMD-PR- 532	1	B 50 x b 30	20,0
CMD-PR- 323	1	B 30 x b 20	30,0
CMD-PR- 763	1	B 70 x b 60	30,0
CMD-PR- 35325-1 side	1	B 35 x b 30	25,0
CMD-PR- 40335-1 side	1	B 40 x b 30	35,0
CMD-SQ-25	1	B 25 x B 25	



CMD-PD

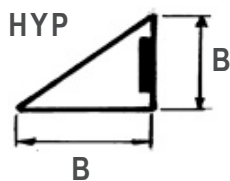

CMD-PS1

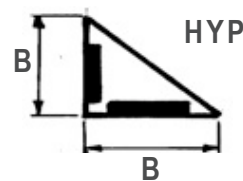

CMD-PS2

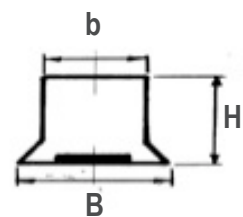

CMD-PM

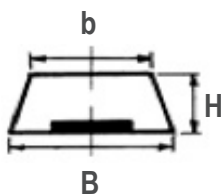

CMD-PR



CMD-PM1

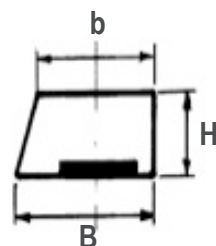

CMD-PR1



CMD-SQ